

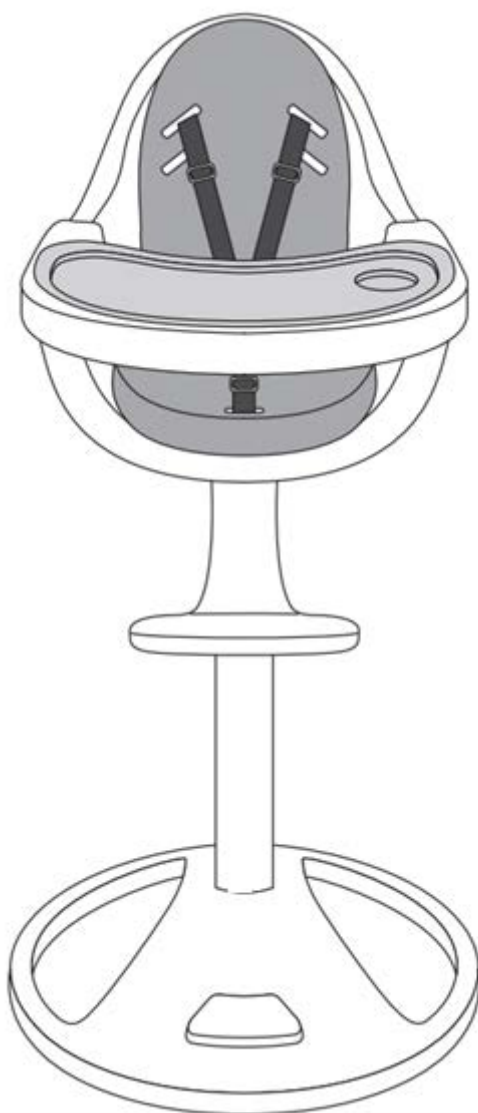

DELUXE PEDESTAL SWIVEL HIGHCHAIR



READ THIS MANUAL

Do not use this product until you read and understand the instructions in this manual.

**KEEP INSTRUCTIONS FOR
FUTURE USE.**

This product is designed to be used by a child who can sit upright unassisted, up to a **MAXIMUM** weight of **18.1 kg.**

WARNING! PREVENT SERIOUS INJURY OR DEATH FROM FALLS OR SLIDING OUT.

WARNING! ALWAYS SECURE CHILD IN THE RESTRAINT. ALWAYS KEEP YOUR CHILD IN VIEW.

WARNING! FOR YOUR CHILD'S SAFETY, FOLLOW ALL LABELS ON THIS PRODUCT AND IN THESE WRITTEN INSTRUCTIONS. DO NOT INSTALL OR USE THIS PRODUCT UNTIL YOU READ AND UNDERSTAND THE WARNINGS AND ASSEMBLY INSTRUCTIONS. FAILURE TO FOLLOW THESE WARNINGS AND THE ASSEMBLY INSTRUCTIONS COULD RESULT IN SERIOUS INJURY OR DEATH.

WARNING! NEVER LEAVE A CHILD UNATTENDED.

WARNING! This product is designed to be used by a child who can sit upright unaided, up to MAXIMUM weight of 18.1 kg.

KEEP THESE INSTRUCTIONS FOR FUTURE USE.

READ ALL INSTRUCTIONS PRIOR TO ASSEMBLY AND USE.

THE CHILD SHOULD BE SECURED IN THE HIGH CHAIR AT ALL TIMES BY THE RESTRAINING SYSTEM.

THE TRAY IS NOT DESIGNED TO HOLD THE CHILD IN THE CHAIR.

WARNING! Remove all packaging and discard. Lay out all parts as per the Parts List to facilitate assembly.

If you experience any difficulties, please contact the Customer Service Department at info@bebestyle.co.uk

REMOVE PACKING MATERIALS AND POLYBAGS, AND DISPOSE OF THEM BEFORE ASSEMBLY. PLASTIC BAGS CAN CAUSE SUFFOCATION. KEEP PLASTIC BAGS AND SMALL PARTS AWAY FROM CHILDREN. ADULT ASSEMBLY REQUIRED. FOLLOW ASSEMBLY INSTRUCTIONS CAREFULLY.

DO NOT use this product without properly assembling it. Keep unassembled parts out of the reach of small children.

! **CHOKING HAZARD**- Small parts: Ensure children do not play with unassembled product, as there are small parts that could cause choking if swallowed.

WARNING! ! THE CHILD SHOULD BE SECURED IN THE HIGH CHAIR AT ALL TIMES BY THE RESTRAINING SYSTEM. THE TRAY IS NOT DESIGNED TO HOLD THE CHILD IN THE CHAIR.

! Snugly adjust harness belt around child.

! NEVER carry or move the high chair with child in it.

! DO NOT place high chair near walls or furniture that the child can push against and tip over.

! When adjusting any part of this product, the child should be clear of all moving parts.

! Be sure both sides of tray are firmly in place.

STRANGULATION HAZARD:

- DO NOT place high chair in any location where there are cords within the child's reach, such as telephone cords, window blind cords, monitor cords, etc.
- Small children or pets can force themselves into very small openings.
- NEVER tie or add anything to the chair (i.e. accessories, toys, etc.) as this may cause serious injury, i.e. choking.

DO NOT EXCEED THE MANUFACTURER'S RECOMMENDED LOAD as this product can become unstable and cause serious injuries.

! Check screws every 1-2 months for looseness and tighten as necessary.

! DO NOT allow others to use this product unless they read & understand all the instructions & Warning labels.

! Extended exposure to weather could affect plastic colour.

! NEVER use the product on stairs or uneven surfaces. Incorrect use or placement of this product is the most common mistake people make which can lead to serious injuries.

! DO NOT use on uneven, wet/slippy, or unsafe surfaces.

! NEVER use near stoves, heaters or other heat sources.

! DO NOT change, tamper with or modify any part of this product.

! DO NOT use this product if it is damaged in any way or has missing parts.

! DO NOT USE THIS PRODUCT AS A STEP STOOL OR LADDER.

! NEVER allow children to climb into the high chair unassisted.

! ALWAYS help child when getting into or out of the high chair.

! NEVER ALLOW CHILD TO USE FOOTREST TO CLIMB IN OR OUT OF HIGH CHAIR.

! DO NOT, EXCEPT AS DESCRIBED IN THESE INSTRUCTIONS, MODIFY THIS PRODUCT, DISASSEMBLE ANY PART OR CHANGE THE WAY THE HARNESS BELTS ARE USED. This includes adding any parts or accessories by other manufacturers as non tested accessories can affect the safety of the product.

! Avoid putting heavy objects on unit.

! AVOID SERIOUS INJURY by keeping fingers away from any moving parts when assembling/adjusting the product and when installing the tray, to prevent finger entrapment and pinching injuries.

! WARNING: FAILURE TO PROPERLY READ, FOLLOW AND USE THESE INSTRUCTIONS AND THE WARNING LABELS CAN CAUSE THE PRODUCT TO TIP OVER AND COULD RESULT IN SERIOUS INJURIES TO YOUR CHILD.

! NEVER allow children to play with or climb into the high chair unassisted.

! NEVER allow children to hang onto the product.

! NEVER place/hang bags, purses, parcels, etc. or any accessory on the chair back, tray or any other parts as it could cause the product to become unstable!

! NEVER allow children to stand on any part of this product.

If you experience any difficulties, please contact the Customer Service Department at info@bebestyle.co.uk

PARTS LIST

- A - Base
- B - Rotation Button
- C - Metal Pole
- D - Seat
- E - 5-point Harness system
- F - Screws x3
- G - Tray
- H - Insert Tray
- I - Footrest
- J - EVA Foam Pad or Fabric Pad (when applicable)



Tools required for assembly:

- Phillips screwdriver (not included).

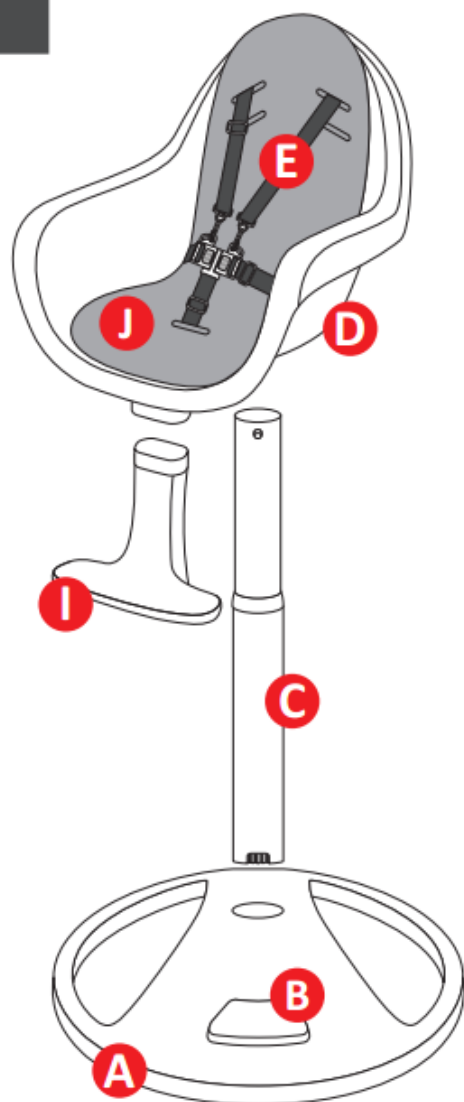

! KEEP THESE INSTRUCTIONS FOR FUTURE USE.

**! READ ALL INSTRUCTIONS PRIOR TO
ASSEMBLY AND USE.**



**PLEASE CHECK TO BE SURE YOU
HAVE ALL OF THE PARTS SHOWN
ON THIS PAGE BEFORE BEGINNING
ASSEMBLY. IF YOU ARE MISSING ANY
PARTS, PLEASE DO NOT RETURN
THIS PRODUCT TO THE STORE.**

PLEASE EMAIL US AT INFO@BEBESTYLE.CO.UK

Before assembly, remove the plastic pieces on each side of the pole, and the plastic protective ring on the pole

HIGH CHAIR ASSEMBLY

1. Align Notch in bottom of metal pole with rotation button in base ①.
2. While pressing the rotation button on base, push metal pole downwards until fully inserted into base ②. Release button.
3. Lie assembly on its side and screw three (x3) screws with washers into base to secure metal pole to the base ③.

! **ENSURE** metal pole is locked into base by gently pulling up on it.

To remove: Unscrew three (x3) screws under base, press rotation button and lift metal pole out of base.

4. Stand assembly upright and find the locking pin located at the top of the metal pole. Press the locking pin while sliding seat onto metal pole to lock into place ④.

! **ENSURE** locking pin locks in place through hole in seat base ⑤. Gently pull up seat to ensure it is secured.

To remove: Press locking clip and lift seat off metal pole.

5. Attach footrest by sliding it up into opening on bottom of seat base ⑥.

! **ENSURE** footrest is locked into seat by gently pulling down on it.

To remove: Press locking clip and pull out footrest.

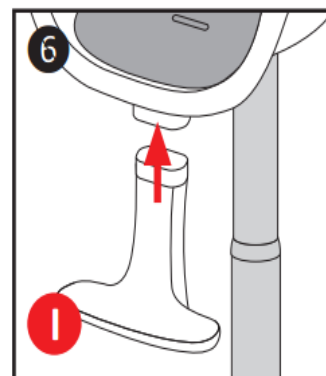
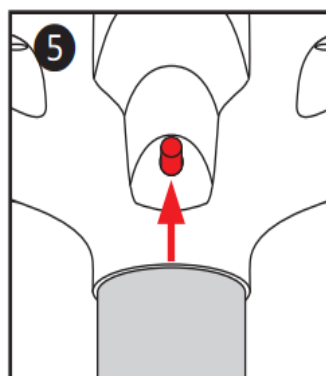
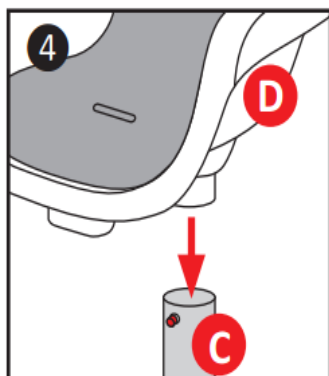
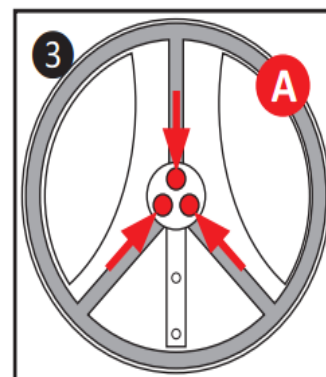
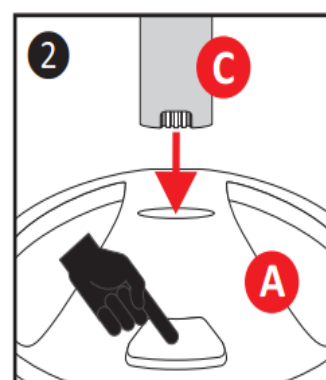
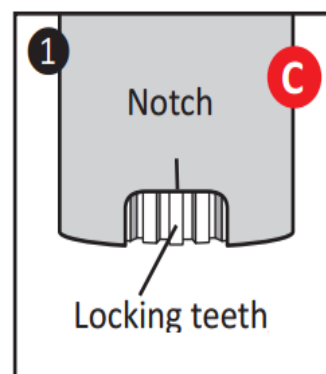

Please note – Make sure the white plastic ring on the pole is firmly pushed down after the height has been adjusted.

USING HIGH CHAIR

WARNING!

FAILURE TO FOLLOW THESE INSTRUCTIONS COULD RESULT IN SERIOUS INJURY OR DEATH.

WARNING!

THIS PRODUCT IS DESIGNED TO BE USED BY A CHILD WHO CAN SIT UPRIGHT UNASSISTED, UP TO A MAXIMUM WEIGHT OF 40 POUNDS (18.1 KG).

WARNING!

ENSURE HARNESS SYSTEM IS SECURE BY PULLING ON IT. CHECK FREQUENTLY. ALWAYS ADJUST HARNESS SNUGLY AROUND YOUR CHILD.

1. Place your child in the seat. With the crotch strap between the child's legs, fasten the 5-point harness by securing both waist buckles to crotch buckle **1**.
2. Adjust the harness so that it fits snugly around the child without causing discomfort. Slide the adjusters on the Shoulder, Waist and Crotch straps to tighten or loosen the harness system **2**.

To release harness: Press both buttons and separate both waist buckles from crotch buckle **3**.

! ALWAYS USE THE CROTCH STRAP IN COMBINATION WITH THE WAIST STRAPS.

! ALWAYS SECURE THE CHILD IN THE RESTRAINT TO AVOID SERIOUS INJURY TO YOUR CHILD FROM FALLING OR SLIDING OUT.

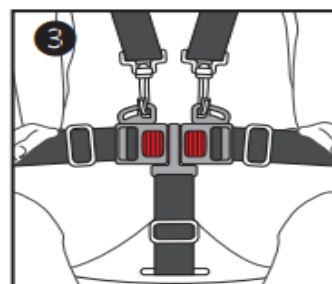
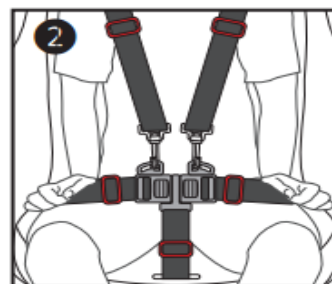
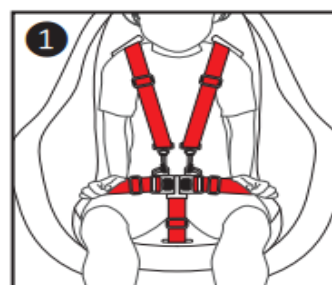

This high chair has **TWO** harness shoulder height positions. Choose the position most suitable for your child.

TO ADJUST HARNESS :

Slide the 2 folded ends of harness shoulder straps on backrest out through the seat **4**.

TO INSTALL HARNESS:

Line up harness straps with openings on front of seat and turn each folded end of the harness strap so that it slides through the front of the seat. Ensure that each folded end of the harness strap is flush against the back of the seat by gently pulling on the front of the harness to ensure harness is locked in place.

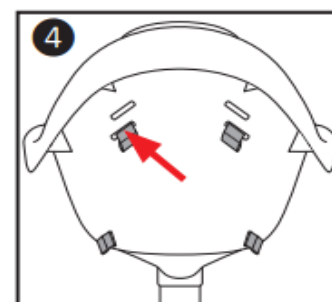

SEAT HEIGHT ADJUSTMENT

WARNING!

FAILURE TO FOLLOW THESE INSTRUCTIONS COULD RESULT IN SERIOUS INJURY OR DEATH.

WARNING!

NEVER ADJUST SEAT WITH CHILD IN IT, THE CHILD SHOULD BE CLEAR OF ALL MOVING PARTS.

This high chair has 1 height positions.

TO RAISE SEAT:

Grasp both sides of seat and lift upwards.

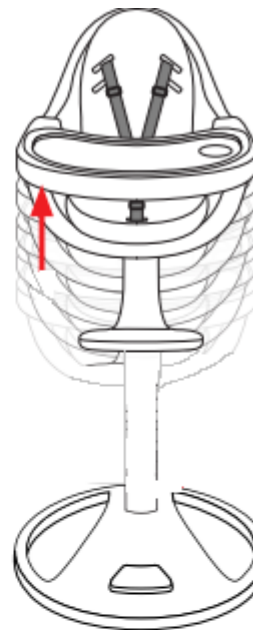

SEAT ROTATION ADJUSTMENT

WARNING!

WHEN ADJUSTING ANY PART OF THIS PRODUCT, THE CHILD SHOULD BE CLEAR OF ALL MOVING PARTS.

TO ROTATE SEAT:

Press on rotation button on base, and rotate seat as desired.

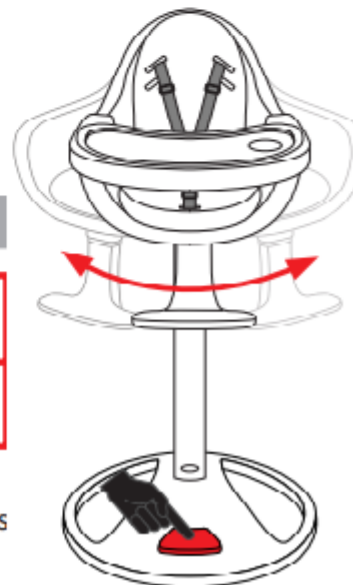

Please note – Make sure the white plastic ring on the pole is firmly pushed down after the height has been adjusted.

INSERT TRAY

TO REMOVE INSERT TRAY:

Lift tab on back of Insert Tray and lift up.

TO INSTALL INSERT TRAY:

Snap tab into place on the Main Tray.

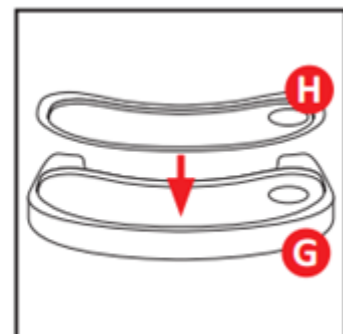

USING TRAY

WARNING! DEATH OR SERIOUS INJURY CAN OCCUR

NEVER USE THE HIGH CHAIR WITHOUT THE TRAY T-BAR PROPERLY INSTALLED.



! WARNING: The child **MUST** be secured in the high chair at all times by the harness system. The tray is **NOT** designed to hold the child safely in the chair.

1. Locate both tabs on tray. Tilt tray upwards and insert both tabs into holes on seat armrests **1**.
2. Tilt tray flat and push down on tray with both hands until a 'click' locks tray in place **2**.
- ! ENSURE** tray is secure by gently pulling up on it.
3. Snap the optional Removable Insert Tray into top of the molded section on the main tray if desired.

To remove tray: Using both hands, gently bend-out tray sides, tilt tray upwards and lift tray off the seat **3**.

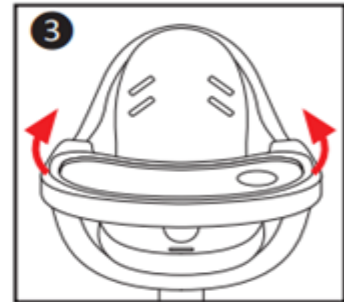
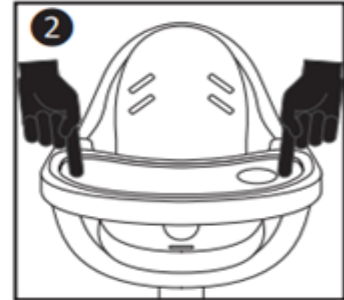
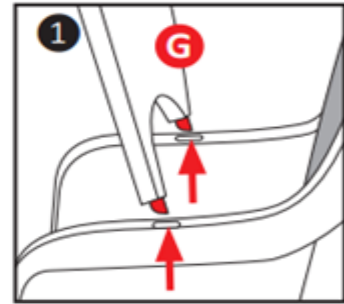

CARE AND MAINTENANCE

SEAT, METAL, PLASTIC AND FABRIC PARTS:

Wipe clean using a damp cloth with mild soap and warm water. **DO NOT** machine wash.

! DO NOT use bleach, detergent or any harsh chemicals.

! DO NOT use an abrasive material as it may scratch the surface.

Insert tray is dishwasher safe (top rack only).

HARNESSES:

The harness straps may be spot cleaned with a mild soap and warm water, and towel dried. **DO NOT** immerse the harness in water. Doing so may weaken them.

Check your product from time to time for loose screws, worn parts, torn material, etc. Tighten, replace or repair parts as needed. Use only Harmony replacements parts.

WARNING: Never leave a child unattended in this product.



Made in China

Bebe Style Ltd NW2BG www.bebestyle.co.uk